

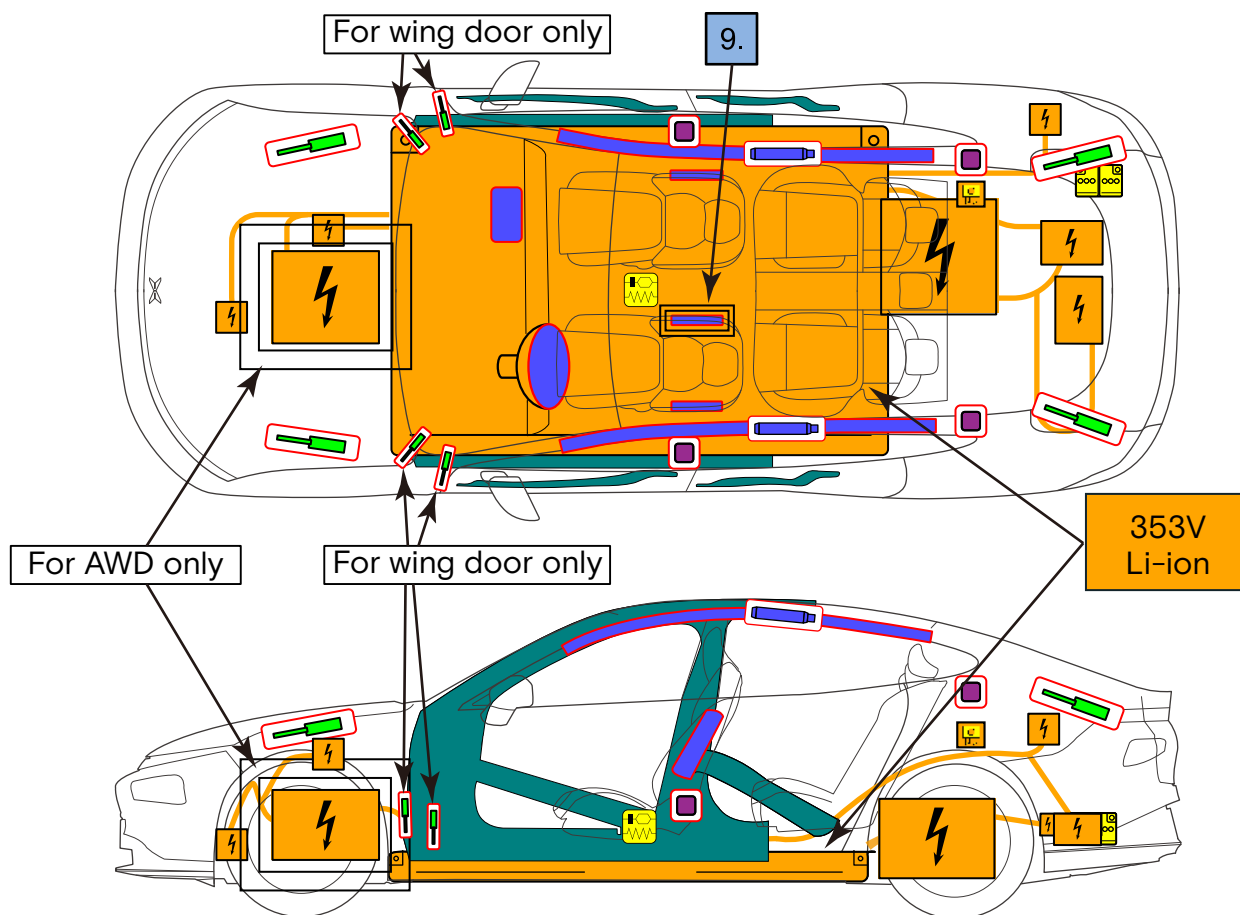

XPENG P7

4 doors sedan
From 2023



	Airbag		Stored gas inflator		Seat belt pretensioner		SRS control unit
	Battery Low Voltage		Gas strut/Preloaded spring		High strength zone		Zone requiring special attention
	High voltage component		Battery pack, high-voltage		High voltage power cable		Fuse box disabling high voltage



XPENG P7
FROM 2023-PRESENT

ID No.

L1N-P7-2023-ERS

Version No.

01

Page No.

1/4



XPENG P7

4 doors sedan
From 2023



1. Identification / recognition



LACK OF ENGINE NOISE DOES NOT MEAN VEHICLE IS OFF: SILENT MOVEMENT OR INSTANT RESTART CAPABILITY EXISTS UNTIL VEHICLE IS FULLY SHUT DOWN. WEAR APPROPRIATE PPE.



2. Immobilisation / stabilisation / lifting

IMMOBILISE THE VEHICLE

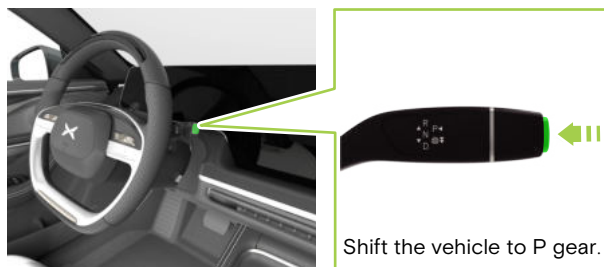

Shift the vehicle to P gear.

LIFTING POINTS

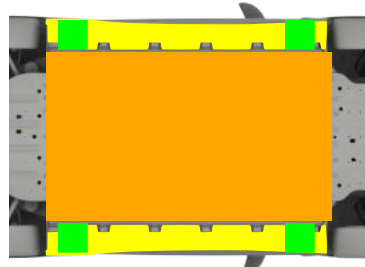

- Appropriate stabilisation-lifting points
- Appropriate stabilisation points vehicle on side
- High voltage battery

3. Disable direct hazards / safety regulations

MAIN DISABLING METHOD

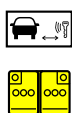

Press and hold for at least 5s.

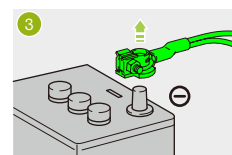

ALTERNATIVE DISABLING METHOD



Pull out highlighted fuse.

ACCESS TO 12V BATTERY

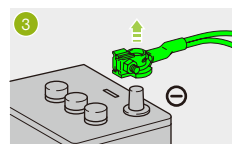

Do not touch, cut, or open high-voltage components and the high-voltage battery! Wear appropriate protective equipment!

In the event of an accident in which the airbags are deployed, the high-voltage system will be automatically deactivated. The high-voltage system is de-energised approximately 60 seconds after deactivation.



XPENG P7
FROM 2023-PRESENT

ID No.

L1N-P7-2023-ERS

Version No.

01

Page No.

2/4

4. Access to the occupants

Door opening



Press the front end of the door handle. Pull the back end of the door handle to open the door.

Seat adjustment



Steering column adjustment





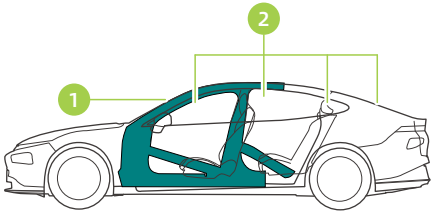



High strength body areas

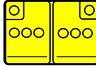

Glas types:
 ① Laminated glass
 ② Tempered glass

The windows cannot be opened after the battery is powered off.

5. Stored energy / liquids / gases / solids

		12V
		353V
		R1234yf 1150g±25g



When coolant leaks from the battery pack, it can become unstable with risk of thermal runaway. Check battery pack temperature with thermal imaging camera.



6. In case of fire



USE LARGE AMOUNTS OF WATER.





BATTERY RE-IGNITION!



7. In case of submersion



Proper PPE should be worn when handling any flooded vehicle. Pull the vehicle out of water as much as possible, immobilise the vehicle and disable the vehicle before starting any operation (see chapter 3).
Tilt the vehicle to one side to allow water to drain out of the vehicle.



XPENG P7

4 doors sedan
From 2023



8. Towing / transportation / storage

STORE AT SAFE DISTANCE FROM OTHER VEHICLES!

Location front hook

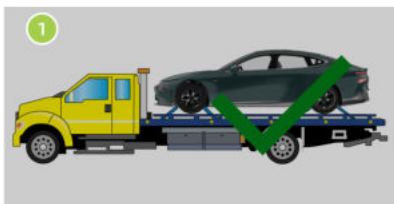
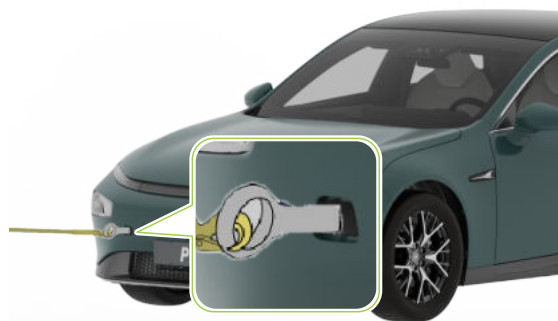

BATTERY RE-IGNITION!



9. Important additional information



Driver's seat has a far side airbag in addition to the side airbag. Location of far side airbag is shown in the mark.

9. on page 1.

10. Explanation of pictograms used

	Electric vehicle		Flammable
	Warning, Electricity		Hazardous to the human health
	General warning sign		Corrosives
	Use water to extinguish the fire		Explosive
	Use thermal Infrared camera		Environmental hazard
	Boot		Acute toxicity
	Air-conditioning component		Remove smart key



XPENG P7
FROM 2023-PRESENT

ID No.

L1N-P7-2023-ERS

Version No.

01

Page No.

4/4