

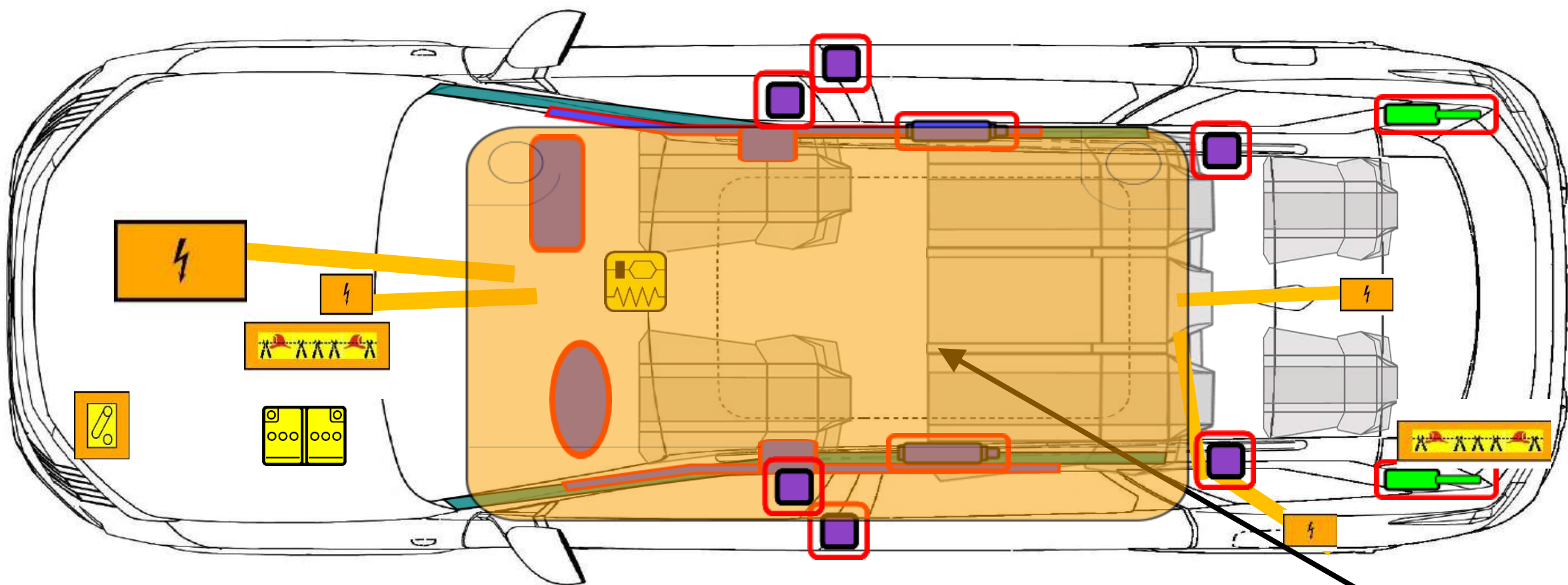

# Peugeot e5008

5 doors/ 5-7 places/ SUV  
BEV (2024/ -> )



400V High voltage

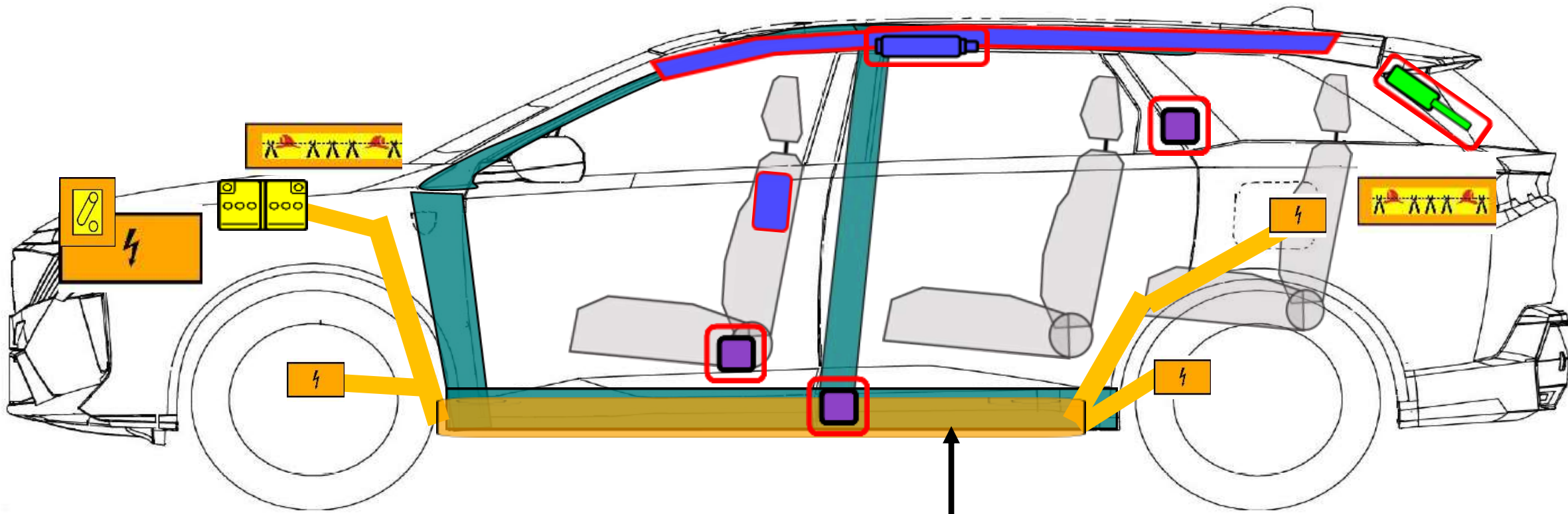

|  |                            |  |                              |  |                        |  |  |  |  |
|--|----------------------------|--|------------------------------|--|------------------------|--|--|--|--|
|  | Airbag                     |  | Stored gas inflator          |  | Seat belt pretensioner |  | SRS control unit   |  |  |
|  | Batterie basse tension     |  | Gas strut / Preloaded spring |  | High strength zone     |  | Composant haute tension  |  |  |
|  | Battery pack, high-voltage |  | High voltage power cable     |  | Coupure de câble       |  | Dispositif de déconnexion basse tension de la batterie haute tension |  |  |



1. Identification / recognition



LACK OF ENGINE NOISE DOES NOT MEAN VEHICLE IS OFF, SILENT MOVEMENT OR INSTANT RESTART CAPABILITY EXISTS UNTIL VEHICLE IS FULLY SHUT DOWN. WEAR APROPRIATE PPE.



Brand logo



Charge port



Model name

2. Immobilisation / stabilisation / lifting

Immobility



Stabilization/lifting points

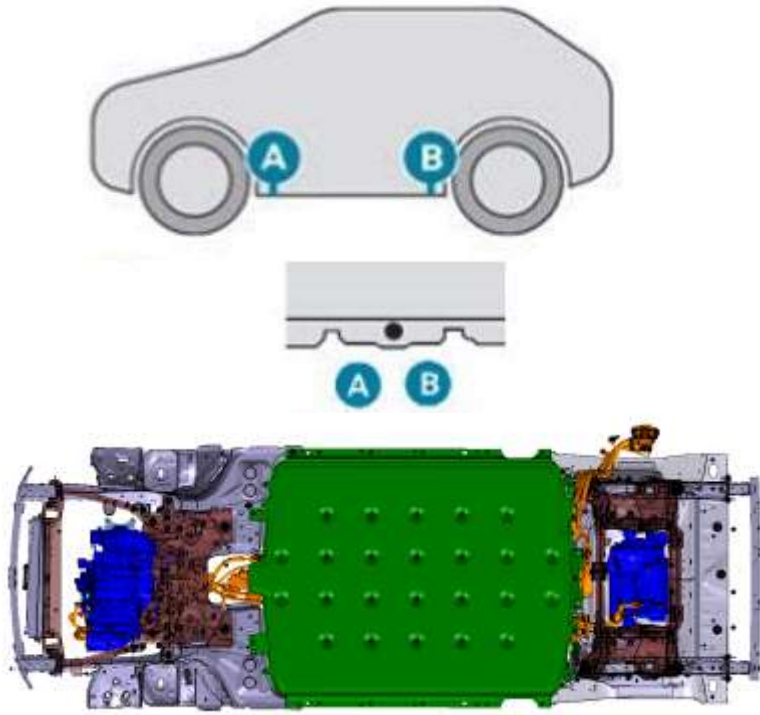

Do not place cribbing such as wooden blocks or rescue air lifting bags under the fuel system or high voltage power cables. Doing so may result in fuel leaks, fire, or electric shock.

3. Disable direct hazards / safety regulations

Main disabling method

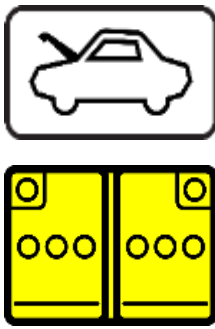
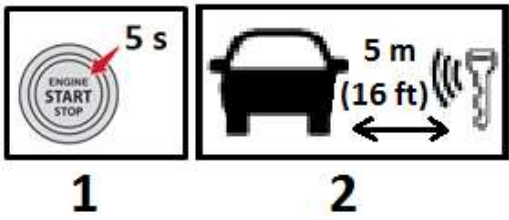

3

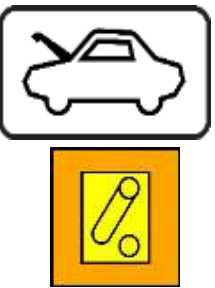
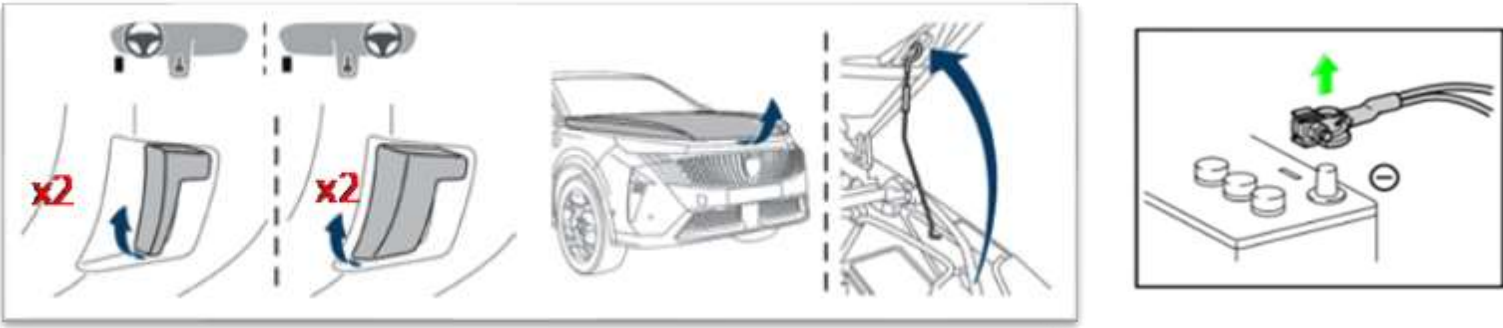

4



5

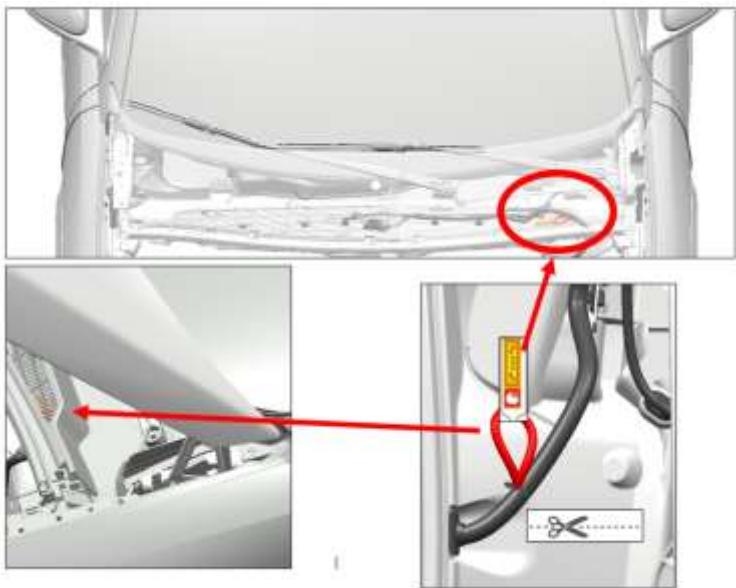

5

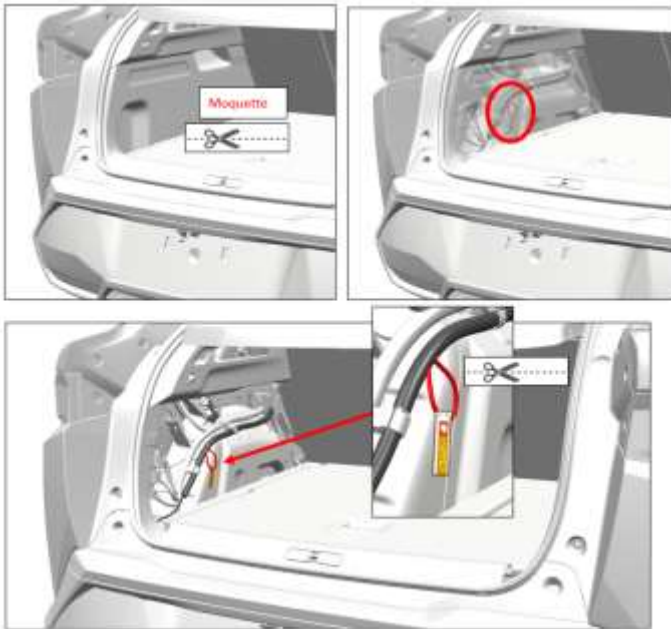



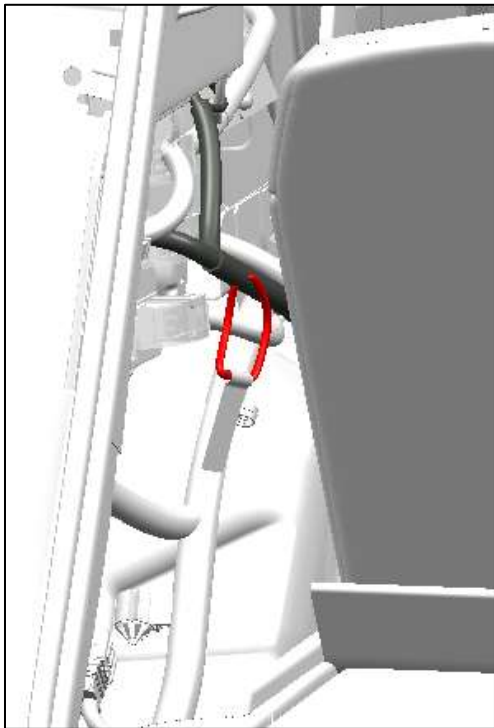
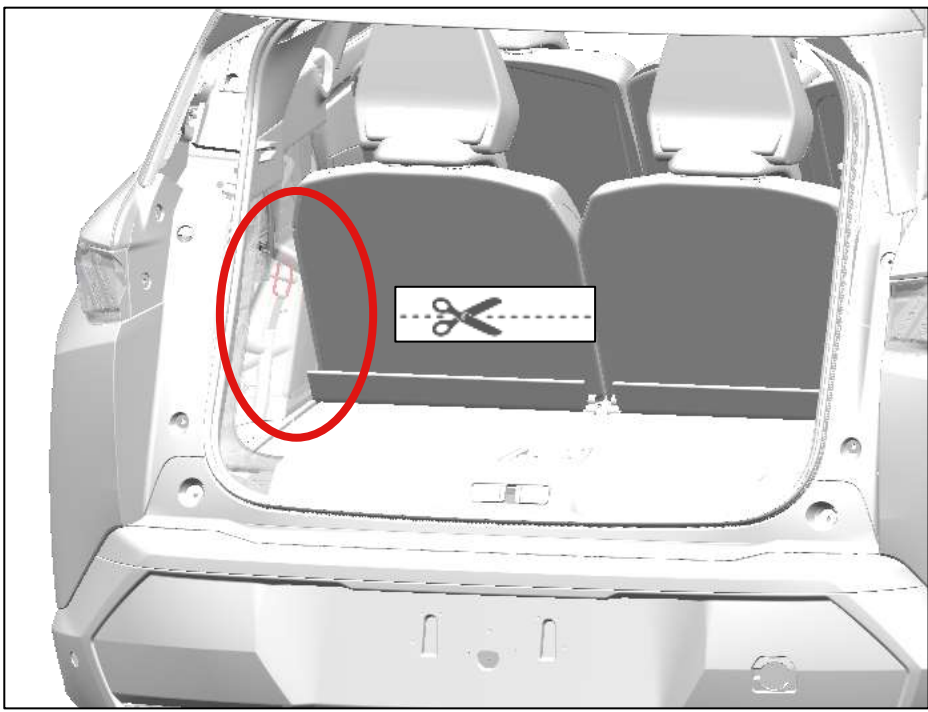
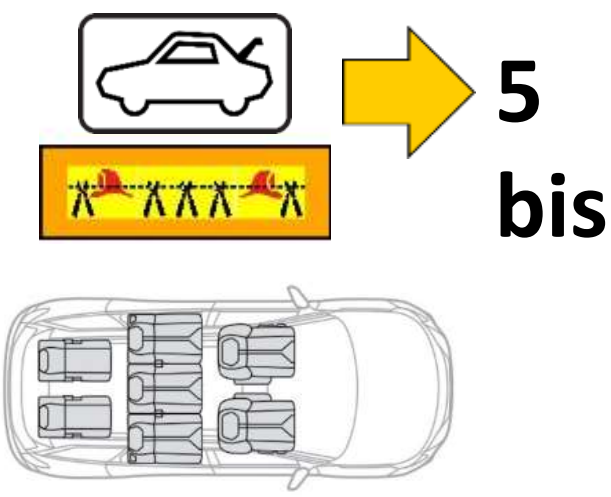

4. Access to the occupants



High strength steel body

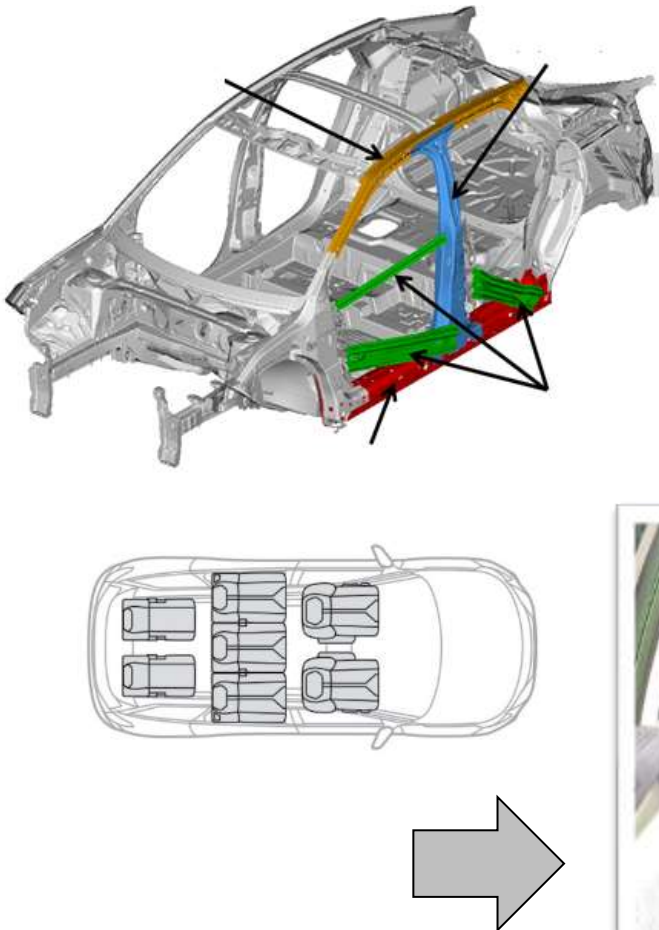

Seat adjustment

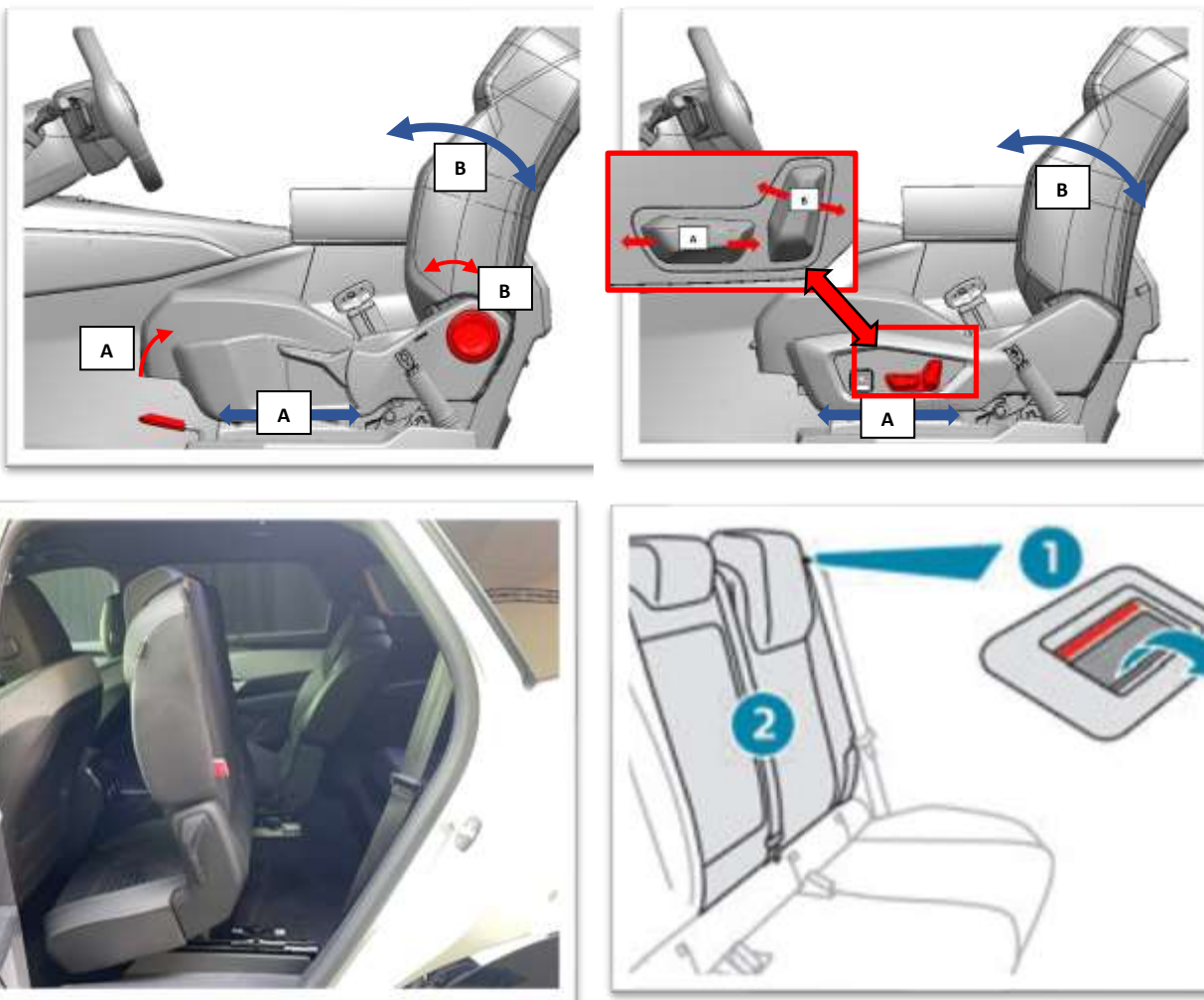

Steering column adjustment

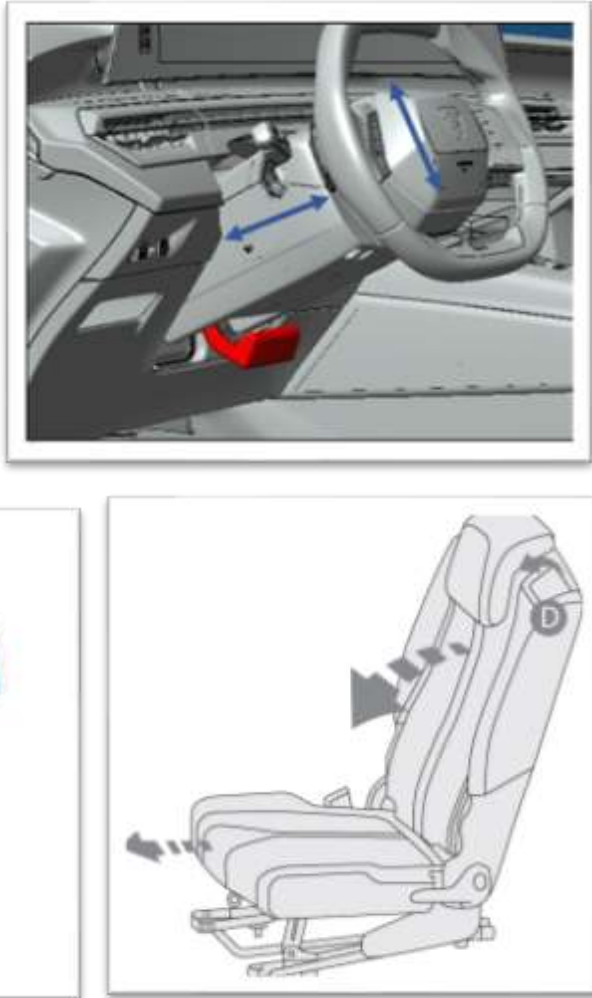

5. Stored energy / liquids / gases / solids

|  |  |  |
|--|--|--|
|  | <b>12V</b>   |  |
|  | <b>400V / Li-ion</b><br>73 kWh (standard range front wheel drive + all-wheel drive)<br>98 kWh (long range) |  |
|  | <b>1234 YF</b>   |  |

when coolant leaks from the battery pack, it can become unstable with risk of thermal runaway. Check battery pack temperature with thermal imaging camera.



6. In case of fire



Use large amount of water



RE-IGNITION POSSIBLE !

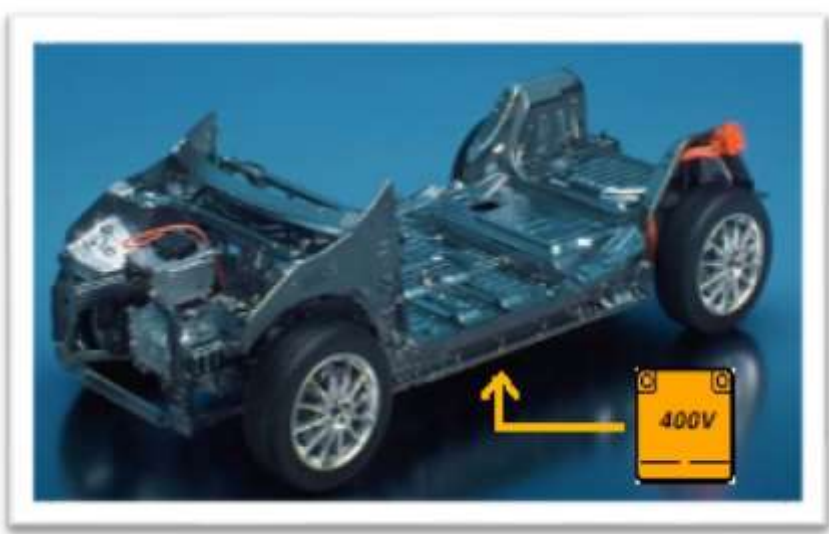

Lithium-ion batteries may self-ignite or reignite once the fire has been extinguished. Monitor the temperature of the high-voltage battery!

7. In case of submersion



Remove the vehicle from the water then refer to chapter 3, Disable direct hazards / safety regulation

8. Towing / transportation / storage

Location front hook

Location rear hook

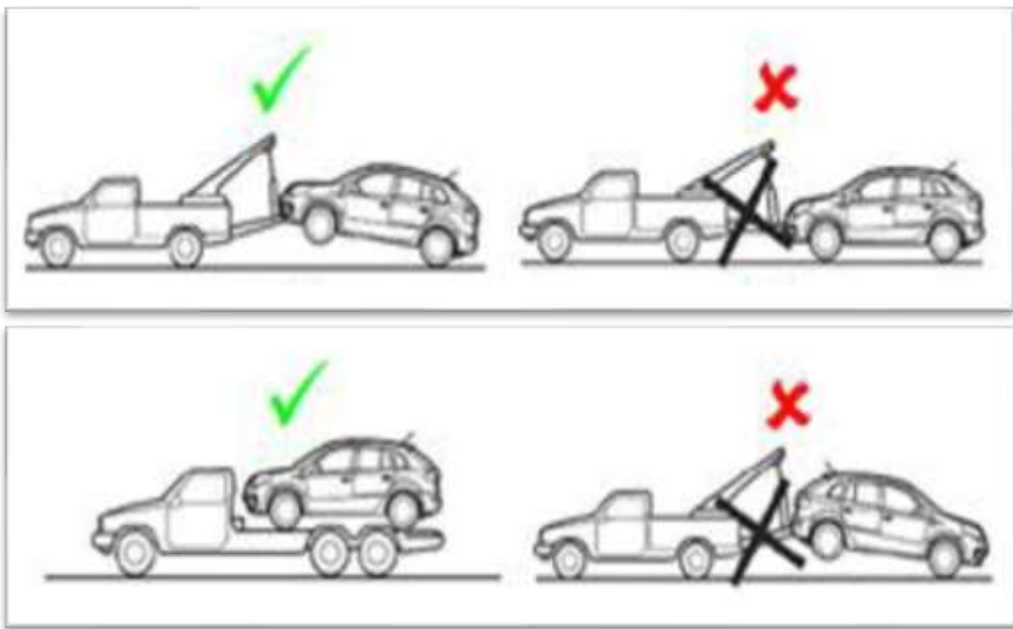
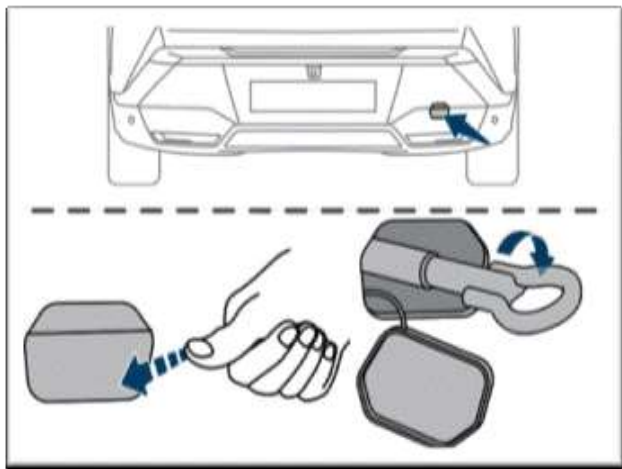
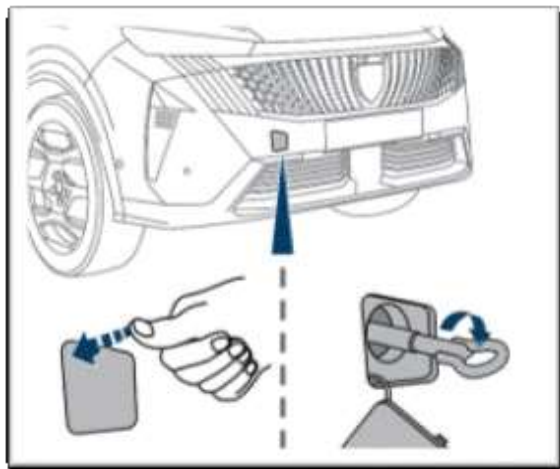

STORE AT SAFE DISTANCE FROM OTHER VEHICLES !



RE-IGNITION POSSIBLE !

9. Important additional information



12V

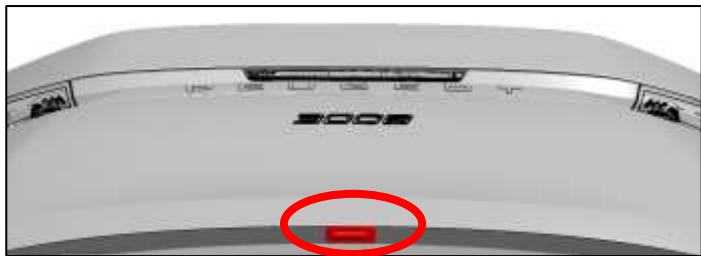
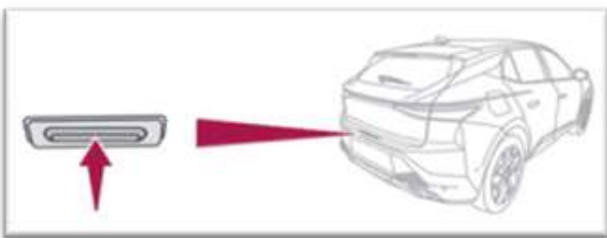

1XV

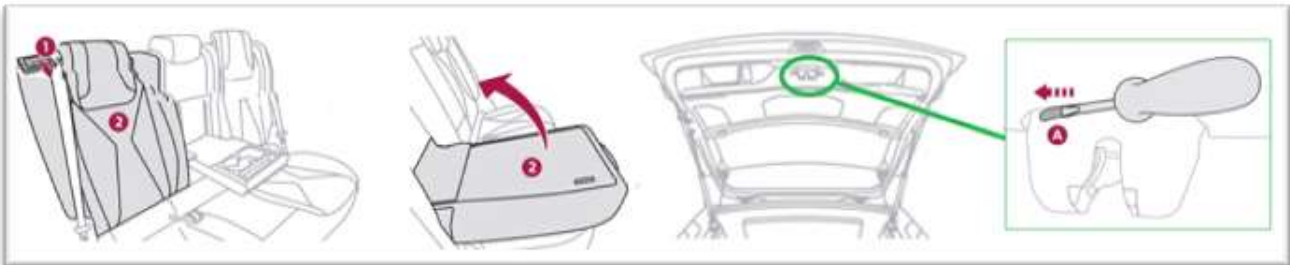

BEV

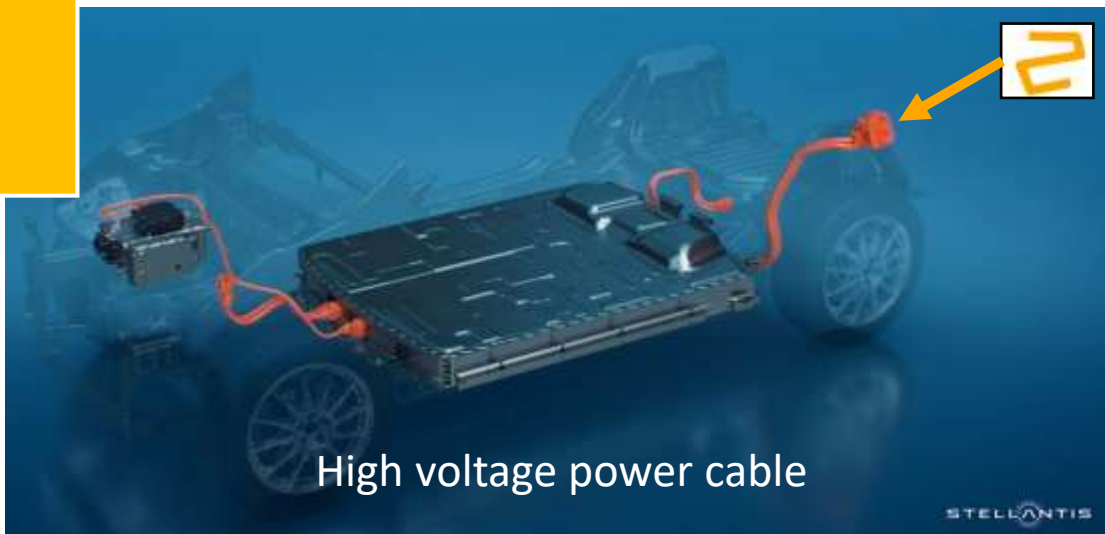

High voltage power cable



High voltage power cable