

315V
340V
380V
Li-ion

	Airbag		Stored gas inflator		Seat belt pretensioner		Gas strut / Preloaded spring
	High strength zone		SRS control unit		Battery low voltage		Battery pack, high-voltage
	High voltage power cable		Low voltage device that disconnects high voltage		High voltage component		
ID Nr.		Version Nr.		Version date		page	
MGS5 EV		1.0		10/2024		Page 1 of 1	



1. Identification/Recognition



LACK OF ENGINE NOISE DOES NOT MEAN VEHICLE IS OFF: SILENT MOVEMENT OR INSTANT RESTART CAPABILITY EXISTS UNTIL VEHICLE IS FULLY SHUT DOWN. WEAR APPROPRIATE PPE.

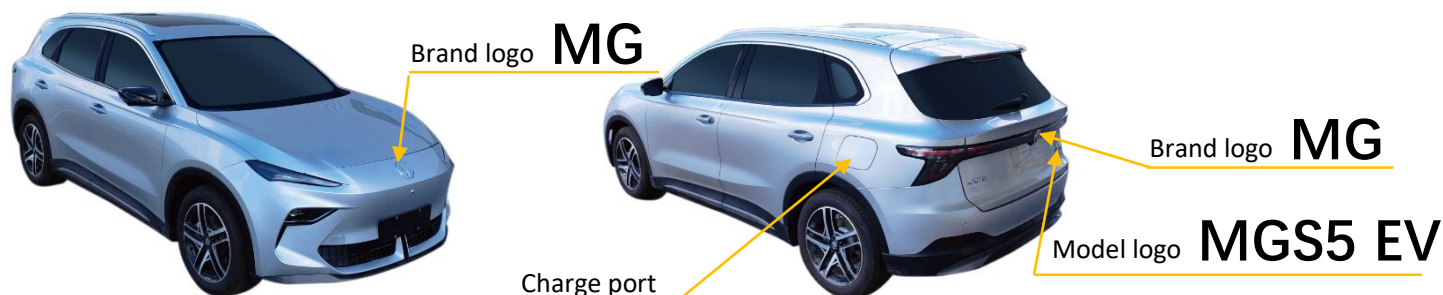

2. Immobilisation/Stabilisation/Lifting

Immobilise the Vehicle

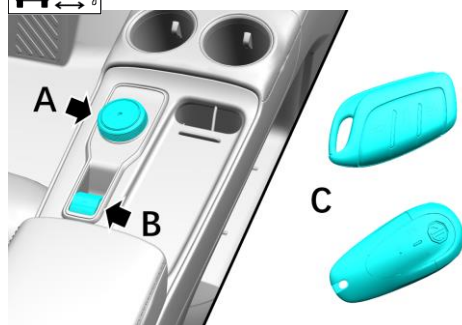

A: Place in P position.
B: Ensure that the parking brake is applied.
C: Exit the vehicle with the key and close all doors, bonnet and tailgate, press the Lock button of the key to turn off the power.

Lifting points

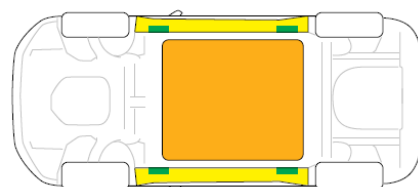

Appropriate stabilisation-lifting points
Appropriate stabilisation points vehicle on side
High voltage battery

Use caution to ensure you never come into contact with the high voltage battery or other high voltage components while lifting or manipulating the vehicle.

3. Disabling Direct Hazards / Safety Regulations

MAIN DISABLING METHOD



In cases of emergency, the high voltage system can be isolated by removing the manual service disconnect device (master safety device). Located under bonnet on LH side.

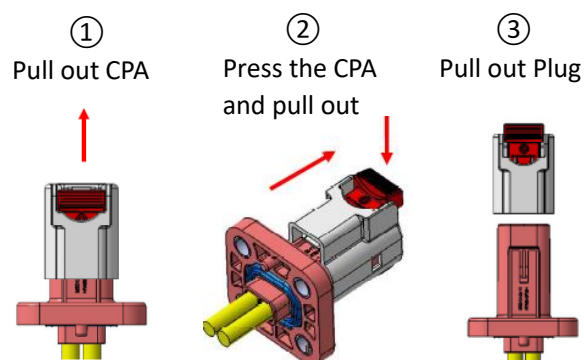

ALTERNATIVE DISABLING METHOD

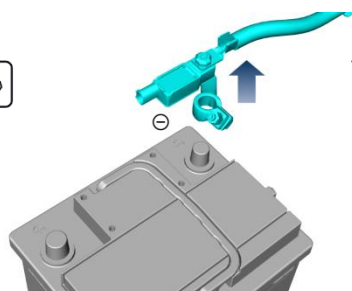

The vehicle power system can be shut down normally.

Power off and disconnect the negative cable of 12V low-voltage battery.

ACCESS to low voltage battery



ID Nr.	Version Nr.	Version date	page
MGS5 EV	1.0	10/2024	Page 2 of 4



4. Access to the Occupants

- ULTRA HIGH STRENGTH STEEL
- NO-CUT ZONES

HV Parts

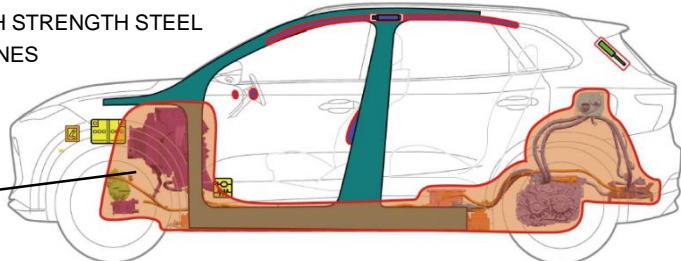

Glass types

- Front window: Laminated glass
- Rear window: Tempered glass
- All door window : Tempered glass

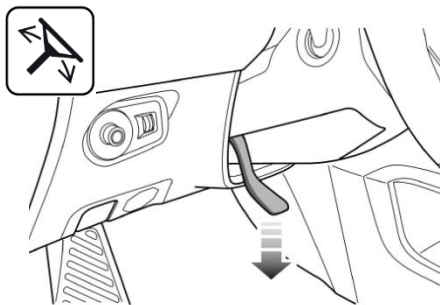

Fully release the locking lever, the steering wheel can be adjusted in 4 directions.

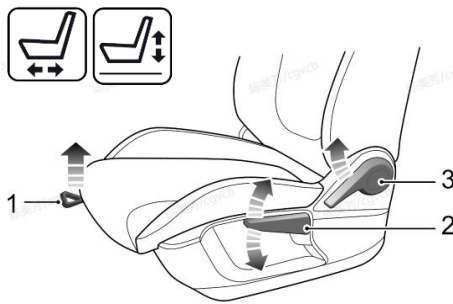

1、 Forward/Backward adjustment (A)

2、 Cushion Height Adjustment (B)

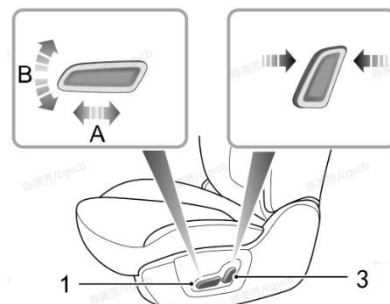

3、 Backrest Adjustment

5. Stored Energy / Liquids / Gases / Solids

		12V
		315V 340V 380V
		Coolant:4.2/5.8L Refrigerant:0.66 ± 0.02kg/0.58 ± 0.02kg



The battery assembly cover should never be breached or removed under any circumstances, including fire. Doing so may result in severe electrical burns, shocks, or electrocution.



When coolant leaks from the battery pack, it can become unstable with a risk of thermal runaway. Check battery pack temperature with a thermal imaging camera.

6. In Case of Fire

**USE LARGE AMOUNTS OF WATER.****BATTERY RE-IGNITION!****DO NOT SUBMERGE VEHICLE TO EXTINGUISH BATTERY.**

- Wear a full set of insulated protection equipment and use specialized insulated tools.
- Disconnect the high-voltage output immediately when conditions permit.
- Continuously spray with a large and constant flow of water.
- Ensure the high-voltage battery is completely extinguished and cooled to avoid reignition.
- To recover the vehicle, do not tow directly, use a recovery vehicle.

ID Nr.	Version Nr.	Version date	page
MGS5 EV	1.0	10/2024	Page 3 of 4



7. In Case of Submersion

- Wear a full set of insulated protection equipment and use specialized insulated tools.
- Avoid touching the metal conductor of the damaged high-voltage device.
- If there is no hissing sound or foam being emitted by the high voltage battery pack, the vehicle can be salvaged by professional organizations.
- After recovery from deep or flood water the vehicle high voltage system must be isolated. For the specific method of disconnecting high-voltage power, please refer to Chapter 3. Isolate the vehicle by placing it in an open location after disconnecting the high voltage.
- To transfer the vehicle, do not tow it directly but use a recovery vehicle instead.

8. Towing / Transportation / Storage

- Personnel are prohibited from staying in the vehicle when towing and transporting the vehicle.
- When using a transporter to ship the vehicle always ensure the parking brake is applied, and the vehicle must be secured as illustrated.
- The vehicle can be towed from the site only when you make sure there is no safety risk. If the battery pack is deformed, leaking or smoking etc., the safety risk should be eliminated first.
- Before towing the vehicle, switch on the hazard warning lamps, close all doors and lock the vehicle. The drive wheels **MUST** be suspended above the ground.
- When towing, **DO NOT** accelerate or brake suddenly, this can cause accidents.

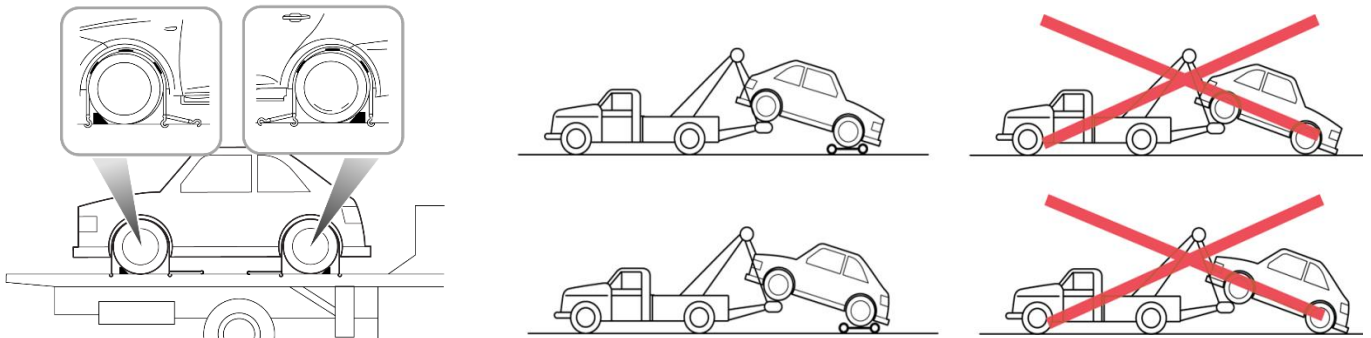

Please consult the Owner's Handbook for detailed instructions

10. Explanation of Pictograms Used

	Electric Vehicle		Warning, Electricity		Air conditioning component		Lifting point		Use thermal Infrared camera
	Steering wheel, tilt control		Seat adjustment, longitudinal		Seat height adjustment		Use water to extinguish the fire		Hazardous to human health
	Flammable		Corrosives		Explosive		Acute toxicity		Bonnet; hood
	Boot; Trunk		Remove smart key /starter key						
ID Nr.		Version Nr.		Version date		page			
MGS5 EV		1.0		10/2024		Page 4 of 4			