

	Airbag		Stored gas inflator		Seat belt pretensioner		SRS control unit		Fuel tank
	Battery low voltage		Gas strut / Preloaded spring		High strength zone		Low voltage device that disconnects high voltage		High voltage power cable
	Battery pack, high-voltage		High voltage component						



1. Identification/Recognition



A LACK OF MOTOR NOISE DOES NOT INDICATE THE SYSTEM IS OFF, A SILENT MOVEMENT CAPABILITY EXISTS UNTIL THE VEHICLE IS FULLY SHUT DOWN. ALWAYS WEAR APPROPRIATE PPE.

Brand logo **MG**



Brand logo **MG**



Model logo **MG3 Hybrid+**

2. Immobilisation/Stabilisation/Lifting

Immobilise the Vehicle

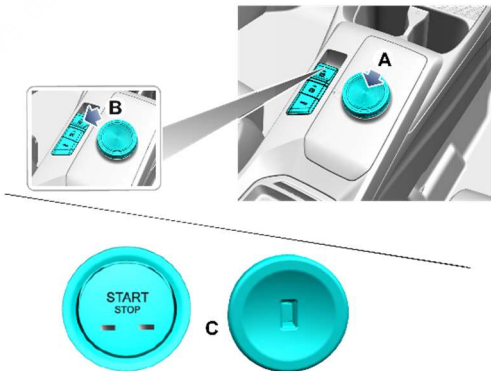

A: Place in P position;
B: Apply the EPB (indicator ON);
C: Operate the Start/Stop switch to turn off the power system.

Jacking or Lifting

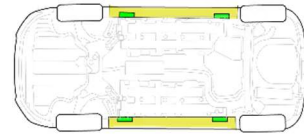

Appropriate stabilisation-lifting points
 Appropriate stabilisation points vehicle on side

Use caution to ensure you never come into contact with the fuel tank or harnesses while lifting or manipulating the vehicle.

3. Disabling Direct Hazards / Safety Regulations

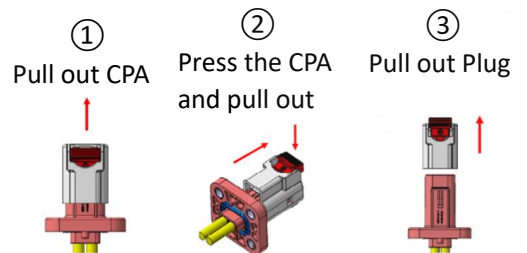
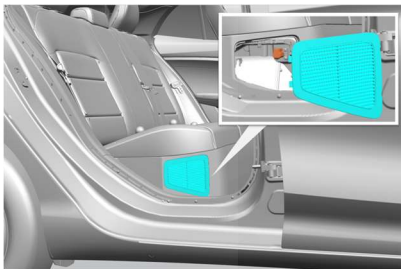

In cases of emergency, the high voltage system can be isolated by removing the manual service disconnect device (MSD). Please remove the cover on the right side of the rear seat, and the MSD and removal diagram can be seen.

ALTERNATIVE DISABLING METHOD

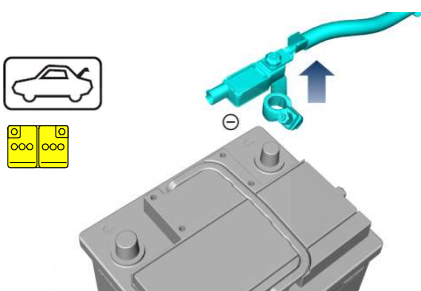

The vehicle power system can be shut down normally.

Power off and disconnect the negative cable of 12V low-voltage battery.

ACCESS to low voltage battery

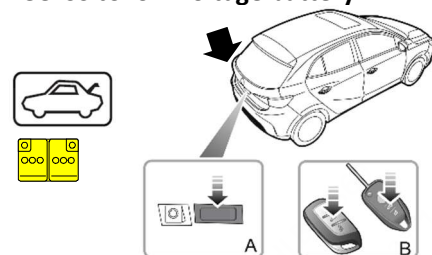

ID Nr.	Version Nr.	Version date	page
MG3 Hybrid+	1.0	02/2025	Page 2 of 4



4. Access to the Occupants

- ULTRA HIGH STRENGTH STEEL
□ NO-CUT ZONES

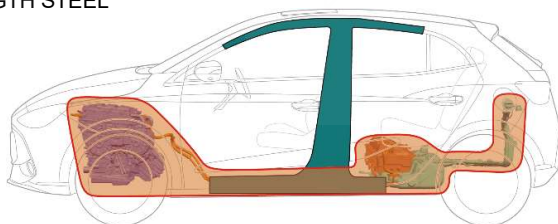

Glass types

- Front window: Laminated glass
- Rear window: Toughened glass
- Four door: Tempered glass

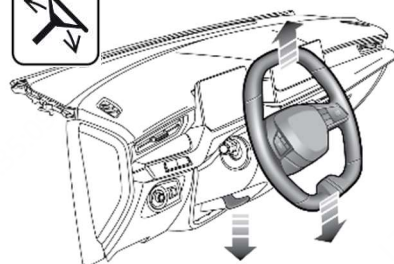

Fully release the locking lever, the steering wheel can be adjusted in 2 directions.



- 1、 Forward/Backward adjustment
- 2、 Cushion Height Adjustment *
- 3、 Backrest Adjustment

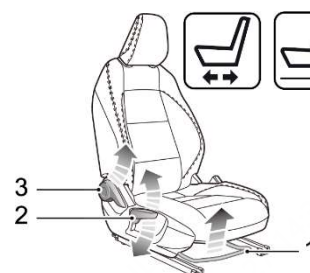

- 1、 Forward/Backward adjustment
- 2、 Cushion Height Adjustment *
- 3、 Backrest Adjustment

5. Stored Energy / Liquids / Gases / Solids

		12V
		403.2V
		Coolant:6.4/3.4L Refrigerant:0.52±0.02kg
		Fuel tank:36 L



The battery assembly cover should never be breached or removed under any circumstances, including fire. Doing so may result in severe electrical burns, shocks, or electrocution.



Internal battery damage may not be detected, it can become unstable with a risk of thermal runaway. Check battery pack temperature with a thermal imaging camera.

6. In Case of Fire



USE LARGE AMOUNTS OF WATER.



BATTERY RE-IGNITION!



DO NOT SUBMERGE VEHICLE TO EXTINGUISH BATTERY.

- Wear a full set of insulated protection equipment and use specialized insulated tools.
- Disconnect the high-voltage output immediately when conditions permit.
- Continuously spray with a large amount of continuous water.
- Ensure the high-voltage battery is completely extinguished and cooled to avoid reignition.
- To recover the vehicle, do not tow it directly, use a rescue vehicle instead.

ID Nr.	Version Nr.	Version date	page
MG3 Hybrid+	1.0	02/2025	Page 3 of 4



7. In Case of Submersion

- Wear a full set of insulated protection equipment and use specialized insulated tools.
- Avoid touching the metal conductor of the damaged high-voltage device.
- If there is no hissing sound or foam being emitted by the high voltage battery pack, the vehicle can be salvaged by professional organizations.
- After recovery from deep or flood water the vehicle high voltage system must be isolated and placed in an open place for isolation.
- To transfer the vehicle, do not tow it directly but use a recovery vehicle instead.

8. Towing / Transportation / Storage

- Personnel are prohibited from staying in the vehicle when towing and transporting the vehicle.
- When using a transporter to ship the vehicle always ensure the parking brake is applied, and the vehicle must be secured as illustrated.
- The vehicle can be towed from the site only when you make sure there is no safety risk. If the battery pack is deformed, leaks, smokes, etc., the safety risk should be solved first.
- Before towing the vehicle, switch on the hazard warning lamps, close all doors and lock the vehicle. The drive wheels MUST be suspended above the ground.
- When towing, DO NOT accelerate or brake suddenly, this can cause accidents.
- When it is necessary to temporarily push or tow the vehicle from a dangerous situation or onto the transporter, the speed must remain below 3 mph (5 km/h) and be completed within 3 minutes.

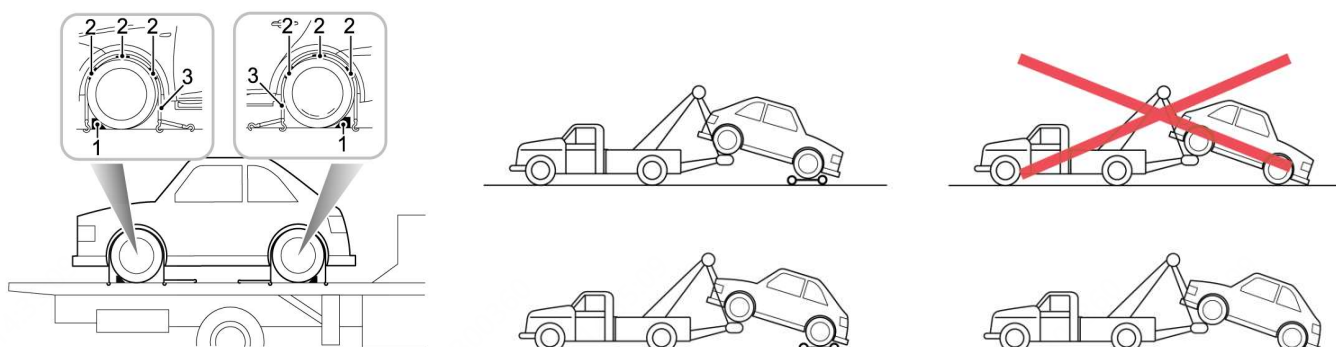

Please consult the Owner's Handbook for detailed instructions

10. Explanation of Pictograms Used

	Battery pack, high-voltage		Warning, Electricity		Airconditioning component		Low voltage device that disconnects high voltage		thermal Infrared camera
	Steering wheel, tilt control		Seat adjustment, longitudinal		Seat height adjustment		Use water to extinguish the fire		Hazardous to human health
	Flammable		Corrosives		Explosive		Acute toxicity		Fuel tank
	Battery low voltage		Boot; Trunk		Remove smart key /starter key				

ID Nr.	Version Nr.	Version date	page
MG3 Hybrid+	1.0	02/2025	Page 4 of 4