

	Airbag		Stored gas inflator		Seat belt pretensioner		SRS control unit
	Battery low-voltage		Gas strut / Preloaded spring		High strength zone		Zone requiring special attention
	Battery pack, high-voltage		High voltage power cable		High voltage component		Cable Cut
	Pedestrian protection active system						

1. Identification / recognition



LACK OF ENGINE NOISE DOES NOT MEAN VEHICLE IS OFF: SILENT MOVEMENT OR INSTANT RESTART CAPABILITY EXISTS UNTIL VEHICLE IS FULLY SHUT DOWN.



Brand Logo Name



Model name



Charging door:



2. Immobilisation / stabilisation / lifting

Immobilisation:

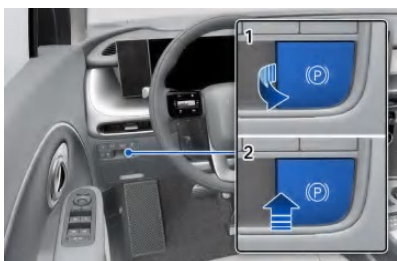

- ① Chock the wheels and pull the electronic parking brake switch to set the parking brake.
- ② For automatic vehicles the shift button to the park(P) position.

For stabilize vehicle, crib at four points directly under the front and rear pillars using wooden blocks or equivalent objects

Lifting points under the vehicle:

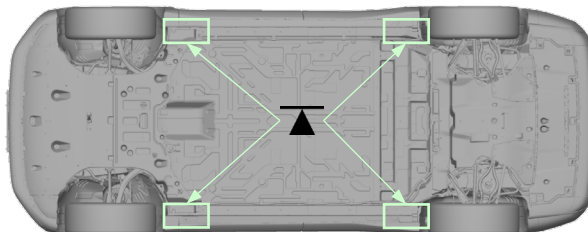

3. Disable direct hazards / safety regulations

IN CASE OF AN ACCIDENT, WHERE AIRBAGS AND SEATBELT PRETENSIONER WERE ACTIVATED, THE HV-SYSTEM SWITCH'S OFF AUTOMATICALLY. FOR ALL OTHER CASES USE THE DISABLING METHODS BELOW



Disabling High Voltage Battery:

Access:

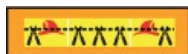

- ① Pull the hood release lever (1) on the driver side.

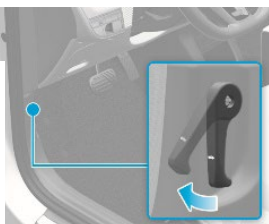

- ② Go to the front of the vehicle. Push the secondary hood release lever (2) to the left.



- ③ Open the cover with the firefighter helmet

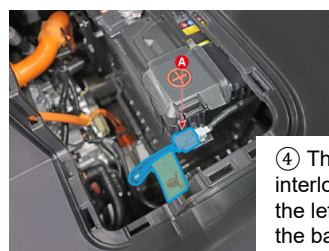

- ④ The service interlock is on the left side of the battery.

Disabling:

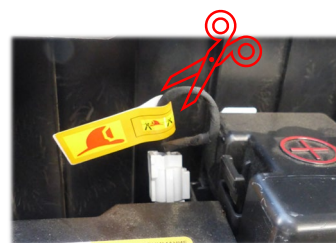

Cut the cable of the service interlock to disable the HV-System

Disabling 12V Battery: Turn the ignition switch off. Follow step ①-③ from disabling HV-method to get access to the 12V Battery

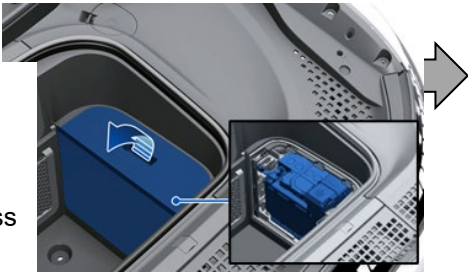
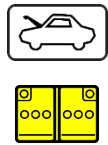

Disconnect the negative(-) terminal

Disconnect the positive(+) terminal

4. Access to the occupants

Steering column adjustment:



Glass:
①②③ : Laminated
④⑤ : Tempered

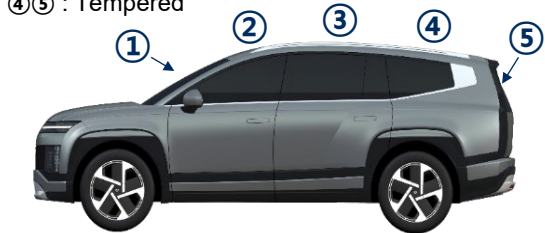

Boot:



Remove the cover at the bottom of the boot, then slide the latch in the direction of the arrow to unlock the boot.

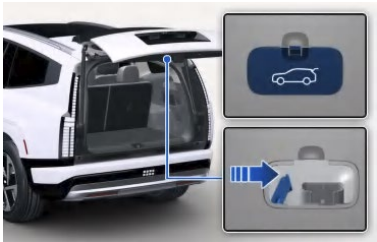

Seat adjustment:

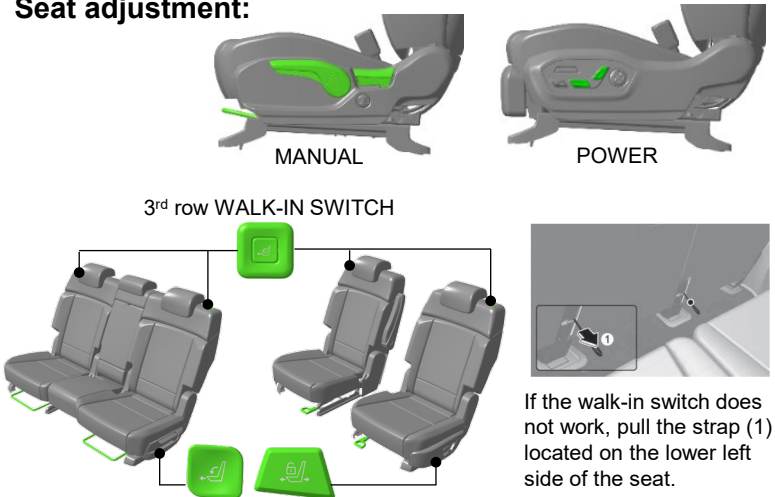

Vehicle body - Ultra-high Strength Steel

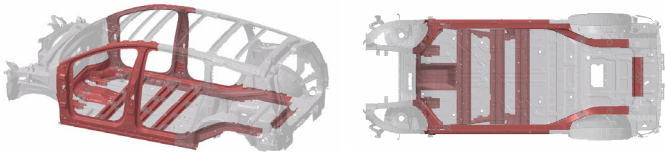

Door handle:

When the door outer handle doesn't pop-up, push the front side inwards.

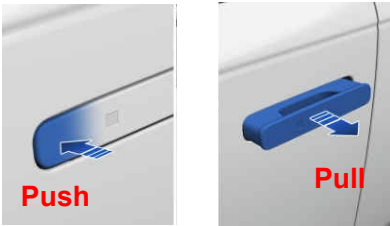

5. Stored energy / liquids / gases / solids

		12V	
		360V	R-1234yf 875g

WHEN COOLANT LEAKS FROM THE BATTERY PACK, IT CAN BECOME UNSTABLE WITH RISK OF THERMAL RUNAWAY. CHECK BATTERY PACK TEMPERATURE WITH THERMAL IMAGING CAMERA

6. In case of fire



Use large amount of water



BATTERY RE-IGNITION!

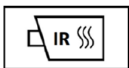

Gas strut!



Risk of missile effect of hood and tailgate.

7. In case of submersion



Do not touch any of the high-voltage components or cables including the high voltage cut-off switch, as doing so poses an electrocution hazard. Work on the vehicle only after the vehicle has been pulled out of the water.



8. Towing / transportation / storage

OK

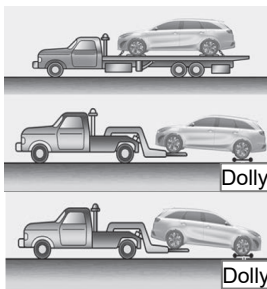

Notice: The use of wheel dollies or flatbed is recommended. Use a wheel lift or flatbed equipment.

Not OK

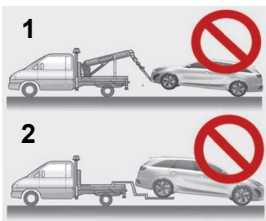

Notice : Do not tow with sling-type equipment (1). Do not tow the vehicle with the front wheels on the ground as this may cause damage to the vehicle (2).

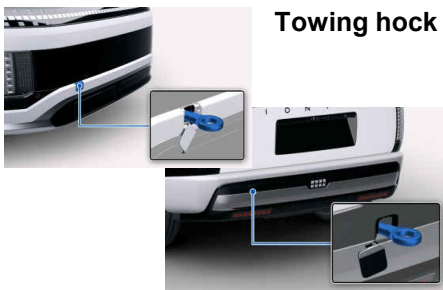

Towing hock

located in the tool case in the boot

The hook must be used only temporary towing.
Store at safe distance from other vehicles

9. Important additional information

7 seater variant → Additional seat in the middle of the 2nd row

10. Explanation of pictograms used

	General warning sign		Warning, Electricity		Electric Vehicle
	Air-conditioning component		Use thermal Infrared camera		Use water to extinguish the fire
	Acute toxicity		Corrosives		Environmental hazard
	Explosive		Flammable		Hazardous to the human health
	Bonnet		Boot		Pedestrian protection active system