

| | | | | | |
|--|----------------------------|--|---|--|------------------------|
| | Airbag | | Stored gas inflator | | Seat belt pretensioner |
| | Gas strut/Preloaded spring | | High strength zone | | SRS control unit |
| | Battery low voltage | | High voltage power cable | | High voltage component |
| | Battery pack, high-voltage | | High voltage device that disconnects high voltage | | |



1. Introduction / recognition



The electric motor is silent. The OK indicator light on the instrument cluster indicates that the current electric drive system is operational. Wear appropriate personal protective equipment.

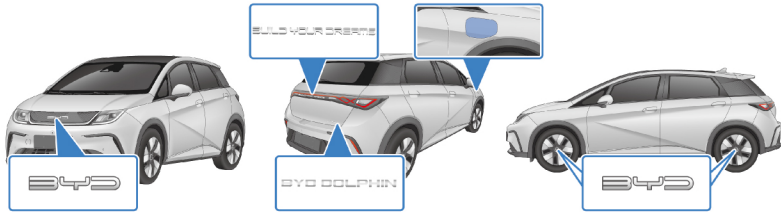

2. Immobilisation / stabilisation / lifting

Immobilise the vehicle

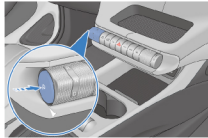

Shift into "P"

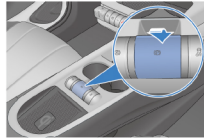

Engage EPB

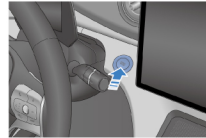

Turn off the ignition

Stabilisation-lifting points

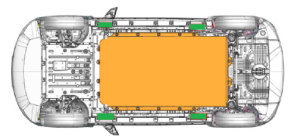

■ Stabilisation-lifting points
■ High-voltage battery

3. Disable direct hazards / safety regulations

Main disabling method

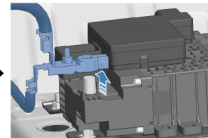
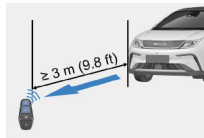
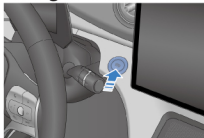

Alternative disabling method

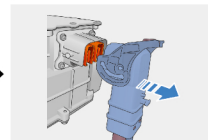
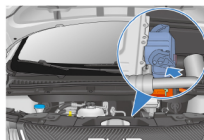
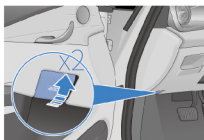

Access to 12V battery

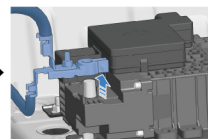
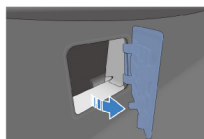

Do not touch, cut, or open high-voltage components and the high-voltage battery! Wear appropriate protective equipment!

In the event of an accident in which the airbags are deployed, the high-voltage system will be automatically deactivated. The high-voltage system is de-energised approximately 60 seconds after deactivation.



4. Access to the occupants

High-strength zone

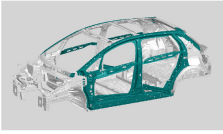

Seat adjustment

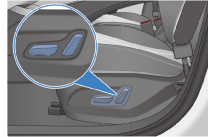

Steering column adjustment

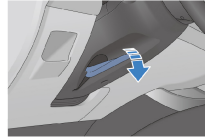

Glass types

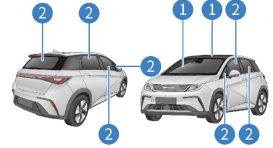

1 Laminated glass

2 Tempered glass

5. Stored energy / liquids / gases / solids

| | | |
|--|--|--|
| | | 12V |
| | | Lithium iron phosphate battery 403.2V |
| | | R1234yf 1000±20g |

When there is coolant leakage, the battery pack may become unstable and there is risk of thermal runaway. The battery pack temperature must be checked with a thermal imaging camera.

6. In case of fire

Extinguish the fire using large amounts of water.

BATTERY RE-IGNITION!

7. In case of submersion

After removing the vehicle from the water, shut off the high-voltage system (see Chapter 3) and drain water out of the vehicle. Appropriate personal protective equipment must be worn during this procedure.



8. Towing / transportation / storage

Front hook location

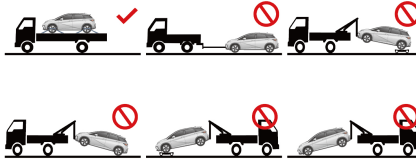

Store at a safe distance from other vehicles!



BATTERY RE-IGNITION!

9. Additional important information

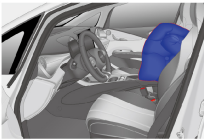

Driver's seat has a far side airbag in addition to the side airbag. Location of far side airbag is shown in the mark 9 on page 1.

10. Explanation of pictograms used

| | | | |
|--|----------------------|--|----------------------------------|
| | General warning sign | | Hazardous to the human health |
| | Remove smart key | | Warning, Electricity |
| | Bonnet | | Air-conditioning component |
| | Flammable | | Warning; low temperature |
| | Explosive | | Use water to extinguish the fire |
| | Corrosives | | Use thermal Infrared camera |
| | Acute toxicity | | |